

A Guide to Benet Academy

Lisle, Illinois



▲
Watch this
inspiring
design-build-
furnish
story!

Project Details

- Project Completed: August 2020
- Overall project cost: \$10.2 million
- 33,000 sq. ft. addition, including a 5,100 sq. ft. Library & Collaboration Center

- Classrooms, multi-purpose spaces, and rehearsal rooms
- Corridor linking east and west campuses
- Gallery space for large events
- New public restrooms
- Additional storage



Benet Academy, a Catholic, Benedictine, college preparatory high school in Lisle, Illinois, is home to more than 1,000 students. With a growing student population, the school needed better flow between the two main areas of the campus. They also wanted additional multipurpose spaces to use for various functions—spaces that would also serve as connection points for students.

Aspen Group designed and developed a unique solution for Benet Academy. The 33,000 sq. ft. addition includes a space for students to develop new skills and opportunities, named St Mary Hall. This facility includes multipurpose rooms for the performing arts, a new Library & Collaboration Center, and an outdoor space for gathering, contemplation, and prayer.

The addition also includes a large gallery space for academic and social events and collaborative work.

Because of this addition of multipurpose areas, Benet Academy had the space they needed to safely reopen in the midst of the pandemic in the fall of 2020.





FIRST FLOOR

KEY:

SECOND FLOOR

- 1 Soft Study/Heritage Gallery
- 2 Library Gallery
- 3 Library/Collaboration Center
- 4 Collaboration/Classrooms
- 5 Rehearsal Rooms
- 6 Multipurpose Rooms
- 7 Storage
- 8 Mechanical
- 9 Custodial
- 10 Elevator
- 11 Kitchenette
- 12 Restrooms
- 13 Offices
- 14 Outdoor Courtyard

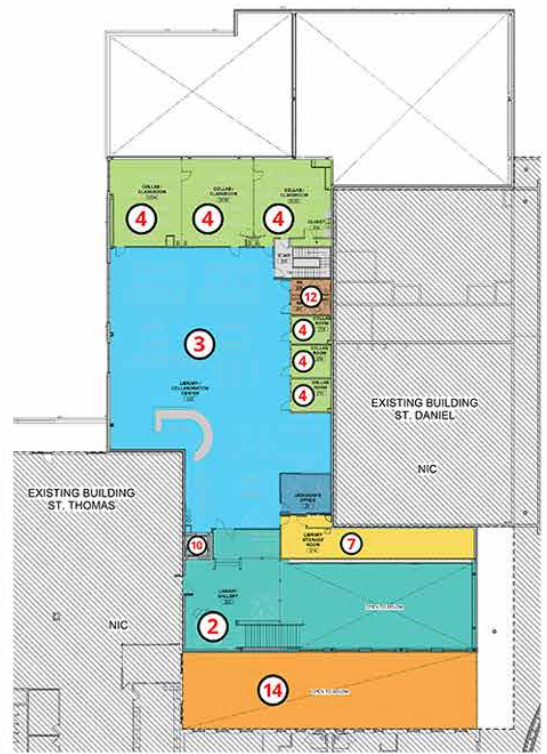



Read more about the Benet Academy addition!



ASPEN GROUP
 Creating Space for Ministry Impact
aspengroup.com

View more design-build-furnish projects: aspengroup.com/portfolio